



rosenthal design



DeltaTherm® FK

The **DeltaTherm® FK** solid fuel boiler controller has been especially developed for systems with solid fuel boilers, water heating stoves or pellet stove heating systems. With the integrated PWM outputs, the FK can manage the speed control of 2 high-efficiency pumps.

With its easily configurable optional functions, the versatile software allows for the control of an electronic mixer for the return mixing function, a thermostatic backup heating, a target temperature control function and many more.

VBus®Touch FK

With **VBus®Touch FK** you can turn your mobile devices into remote data displays for your RESOL controller with a solid fuel boiler function.

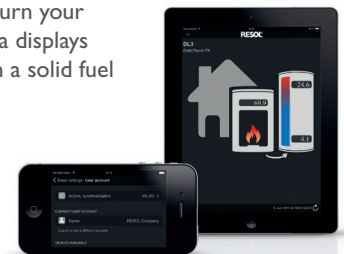

The biomass specialist!

- 2 relay outputs, 4 temperature sensor inputs
- 2 PWM outputs for the speed control of high-efficiency pumps
- Control of an electronic mixer for the return mixing function
- Heating backup
- Heat exchange function
- Thermostatic backup heating

In order to connect sensor 4 to the controller, a sensor adapter cable is required

Article no.	Article	Price bracket
115 002 83	DeltaTherm® FK – Solid fuel boiler controller	A
115 002 93	DeltaTherm® FK – Full kit » incl. 3 Pt1000 sensors (1 x FKP6, 2 x FRP6)	A

EXAMPLES

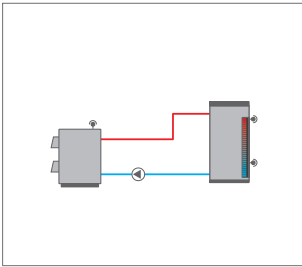

Solid fuel boiler

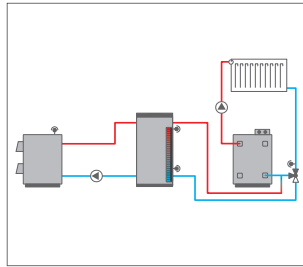

Solid fuel boiler with heating circuit return preheating

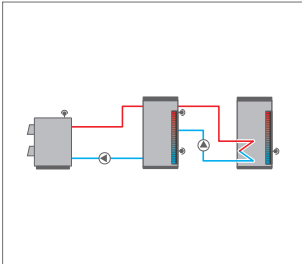

Solid fuel boiler with heat exchange control

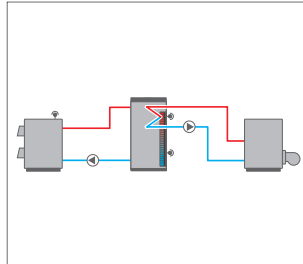

Solid fuel boiler with thermostatic backup heating

TECHNICAL DATA

Inputs: 4 Pt1000 temperature sensors

Outputs: 2 semiconductor relays, 2 PWM outputs

PWM frequency: 1000 Hz

PWM voltage: 10.5 V

Switching capacity: 1 (1) A 240 V~ (semiconductor relay)

Total switching capacity: 2 A 240 V~

Power supply: 100–240 V~ (50–60 Hz)

Supply connection: type X attachment

Standby: 0.46 W

Mode of operation: type 1.C.Y action

Rated impulse voltage: 2.5 kV

Data interface: RESOLVBus®

VBus® current supply: 35 mA

Functions: minimum and maximum temperature limitation, mixer control for the return mixing function, target temperature control, speed control, heating circuit backup, thermostatic backup heating, heat exchange, PWM pump control, operating hours counter

Housing: plastic, PC-ABS and PMMA

Mounting: wall mounting, mounting into patch panels is possible

Indication/Display: full graphic display

Operation: 3 buttons

Ingress protection: IP 20/EN 60529

Protection class: I

Ambient temperature: 0 ... 40 °C

Degree of pollution: 2

Dimensions: 172 x 110 x 46 mm

ELECTRICAL CONNECTION

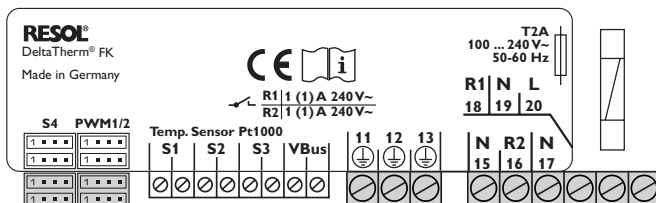

ACCESSORIES

DL2 Datalogger



For visualisation via VBus.net, incl. SD card and network cable, mains adapter and VBus® cable pre-connected

VBus®/USB interface adapter



PC connection kit for RESOL controllers with VBus® incl. Service CD

SDFK Smart Display



Display module with 3 displays for biomass boiler temperature and store temperature as well as for the pump status

AM1



Alarm module for signalling system failures

VBus®/LAN interface adapter



Network connection set for RESOL controllers with VBus® incl. Service CD

Sensor adapter cable



JST adapter cable for systems in which the 4th sensor is required