

MA10/MA25 DHW thermostatic mixing valve

(scald protection for potable water and DHW systems)

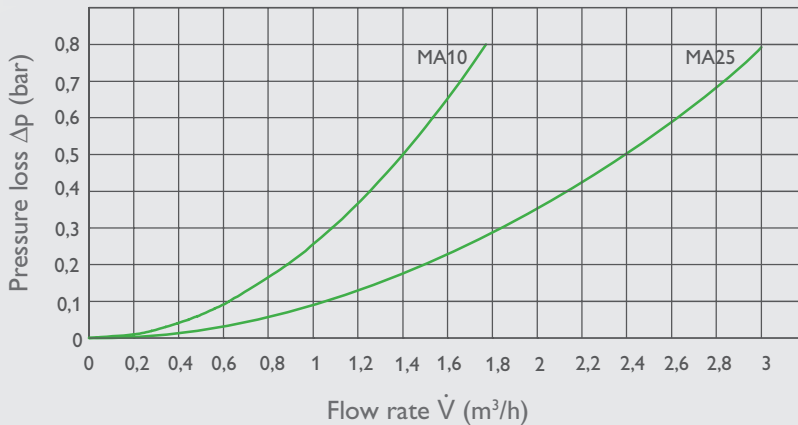

Suitable for
thermosiphon systems



Thermostatic mixing valve for installation into hot water circuits as scald protection.

The thermostatic mixing valve MA10/MA25 is used for limiting the hot water temperature, e. g. in thermosiphon systems or in solar potable water systems.

- No auxiliary electric energy required
- Continuously adjustable between 35 ... 65 °C
- Installation in the hot water flow, in systems with stub or circulation pipes
- Screwed or soldered connections possible
- Any installation position possible

RESOL MA10

Thermostatic mixing valve, ET R 1"

Price bracket B | Article no.: **280 013 40**

RESOL MA25

Thermostatic mixing valve, ET R 1 ¼"

Price bracket B | Article no.: **280 015 50**

Reducing bushes

ET ¾", Set of 3 units for MA10

Price bracket B | Article no.: **280 013 50**

Reducing bushes

ET 1", Set of 3 units for MA25

Price bracket B | Article no.: **280 015 60**

Larger quantity? Ask for an offer!

Technical data

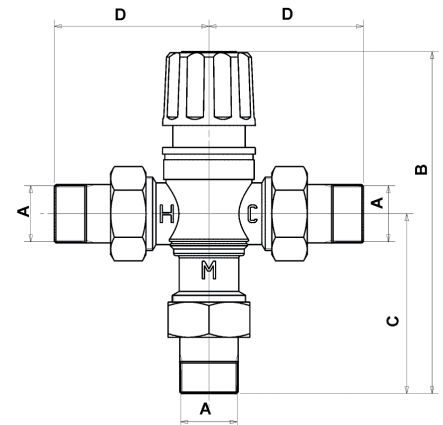

	A	B	C	D
MA10	R ¾"	149 mm	81.5 mm	70 mm
MA25	R 1"	121.5 mm	50 mm	38.5 mm

H = hot water inlet

C = cold water inlet

M = mixed water outlet

Housing: dezincification-resistant brass

Guide component: PTFE

Internal seal: EPDM

External seal: asbestos-free, flat-sealing

Operating pressure: max. 10 bar

Max. temperature hot water inlet: max. 90 °C

Adjustment range mixed water outlet:
35 ... 65 °C

Example

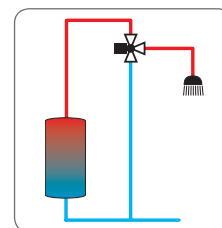

Solar thermal DHW system

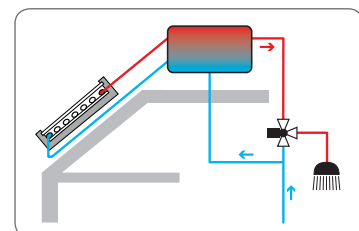

Thermosiphon system